

PLAN SHOWING THE PROPOSED LAYOUT IN SY NO'S : 6/6P, 6/7P, 6/8P, 6/13P, 6/14P, 6/15P, 6/16, 6/17, 6/19, 6/22, 13/P, 15, 33/1P, 33/2P, 33/3P, 33/4, 33/5P, 33/14P, 33/15P, 33/22P, 33/24P, 33/25P, 320/P, 321/P, 341/P, 342, 350/P & 351/P. VELJERLA (VILLAGE), FAROOQ NAGAR (MANDAL), MAHABOBNAGAR (DISTRICT).

LAND BELONGS TO: SPECTRA INDIA HOUSING (P) LTD.  
Rep.M.JAGAN MOHAN

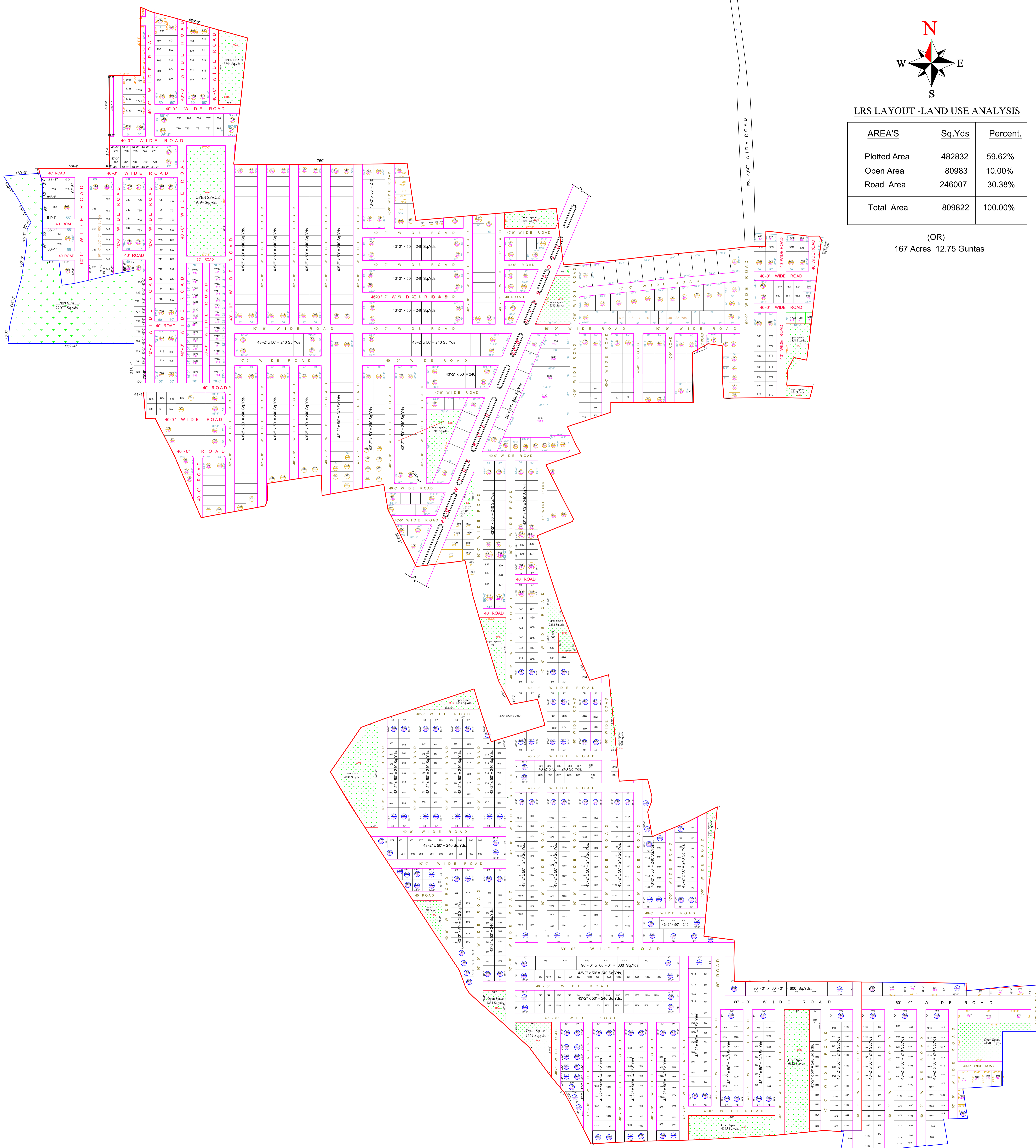

LRS LAYOUT -LAND USE ANALYSIS

| AREA'S            | Sq.Yds        | Percent.       |
|-------------------|---------------|----------------|
| Plotted Area      | 482832        | 59.62%         |
| Open Area         | 80983         | 10.00%         |
| Road Area         | 246007        | 30.38%         |
| <b>Total Area</b> | <b>809822</b> | <b>100.00%</b> |

(OR)  
167 Acres 12.75 Guntas